

# Control Traffic Zone

Traffic control scheduled time for RACES ONLY

特別協賛



**CTZ date**

**Nov. 12 Sun**

CONTACT  
**TOUR DE OKINAWA Convention Office**  
**TEL0980-54-3174**

※The scheduled time may change depend on the situations.

- During the races, one lane to Kunigami becomes two-way traffic and the lane to Naha is closed from Minato 1-chome crossing up to Isagawa crossing on Route 58. From Genka to Inamine will be one-sided mutual way.
- Traffic regulations will start from the restriction police car passes through the area then end at the deregulation police car passes through the area.
- Follow the instructions of the police and staff during the competition in order to operate safely. Thank you for your cooperation.

**KEIRIN**  
競輪の補助事業

この事業は、競輪の補助を受けて実施します。  
公益財団法人 JKA  
<http://hojo.keirin-autorace.or.jp>

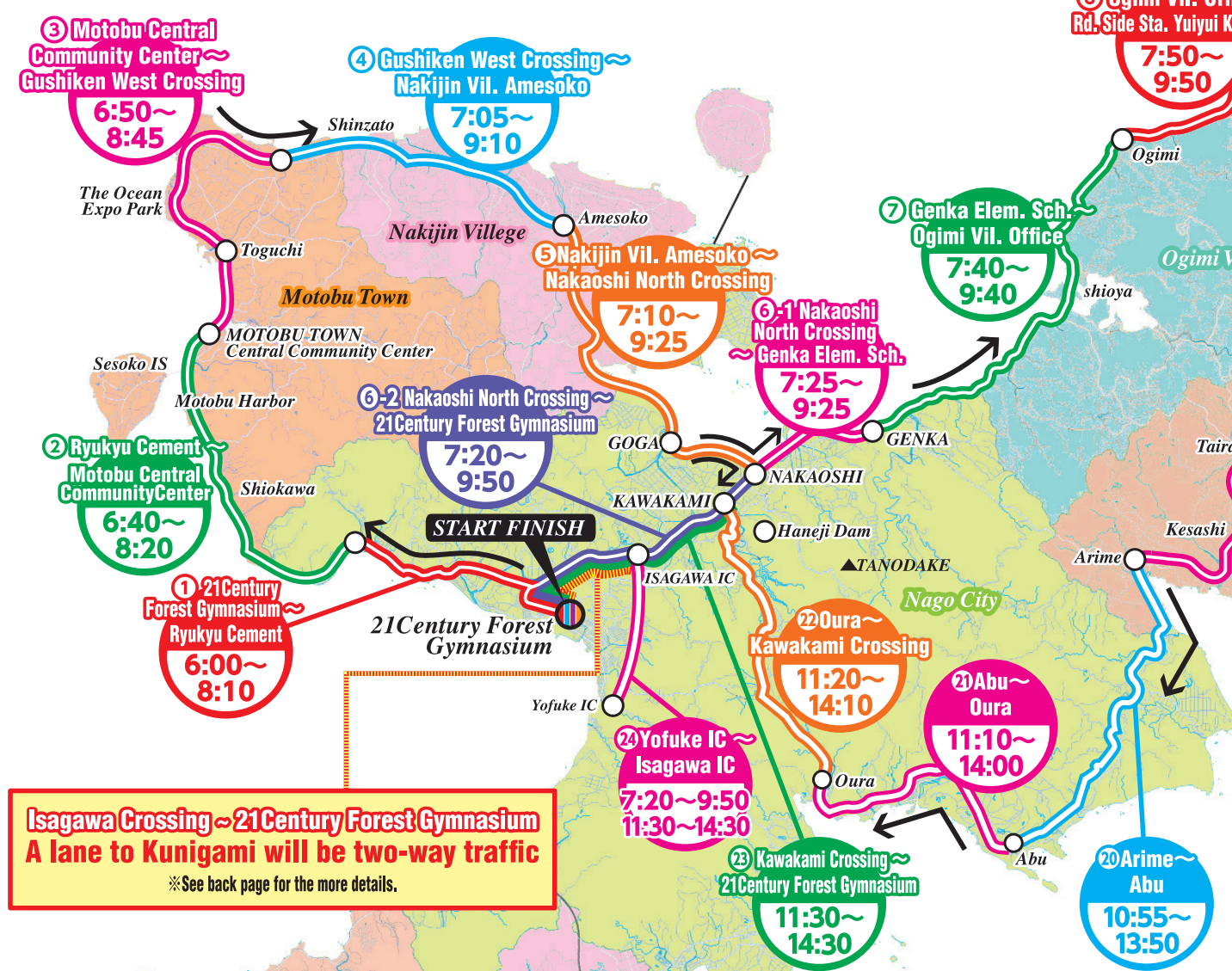

**Isagawa Crossing ~ 21Century Forest Gymnasium**  
**A lane to Kunigami will be two-way traffic**  
※See back page for the more details.

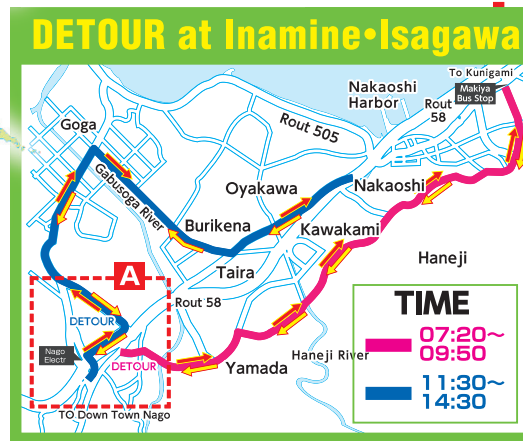

※ The scheduled time may change depend on the situations.

The 29th Tour de Okinawa 2017 will be held on Saturday November 11th and Sunday 12th. This tournament is in order to aim the activation of Yanbaru. The race categories include 18 events and the cycling categories include 7 events. A total of 25 events include unicycle and the tricycle tournaments as well. Over 5,000 players participate from home and abroad. To support this tournament, Women's Associations, Youth Associations, Fire Brigade, Traffic Safety Association and etc. from the region as volunteers of over 3,000 people will join cooperation as attendant.

During the competition of the Tour de Okinawa, please follow the traffic safety precautions listed below.

- The race courses, listed in the back of this page, during the competition on Sunday, November 12 will be fully under the traffic regulations. (Some area will be one way traffic regulations)
On Sunday, November 12 during the competition, from Route 58 Minato 1-chome intersection to Isagawa intersection will be face-to-face way of the Naha bound in the outbound lane. Inbound lane (To Naha) will be closed to traffic. Between Genka to Inamine and between Oura on Rout 331 to Kanucha Bay Hotel will become the one side alternating traffic. Outbound lane of From rout 449 Miyazato 4-chome intersection (North) to entrance of Ohama Crossing and from Motobu Ohashi bridge (North) to Motobu Urasaki intersection becomes closed to traffic. Other lanes will be entirely closed to traffic.
Follow the instructions of the police and staff during the competition in order to operate safely. Thank you for your cooperation.

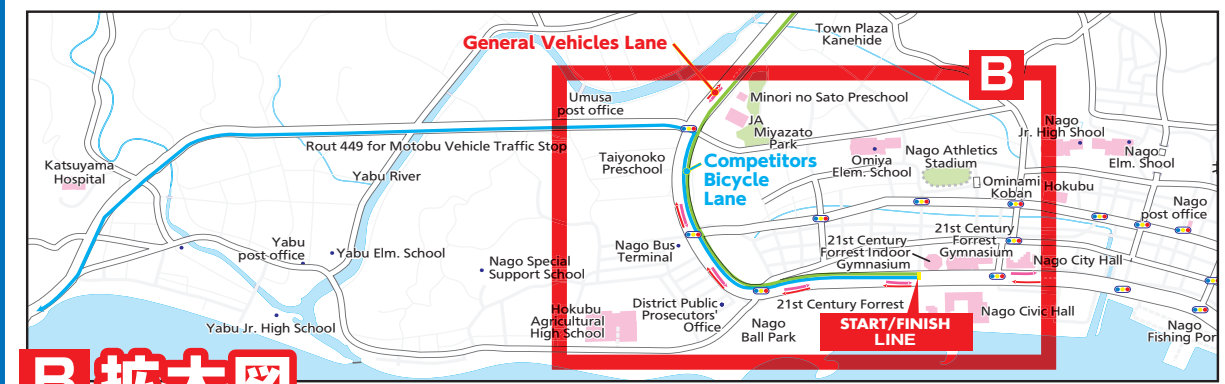

B 拡大図

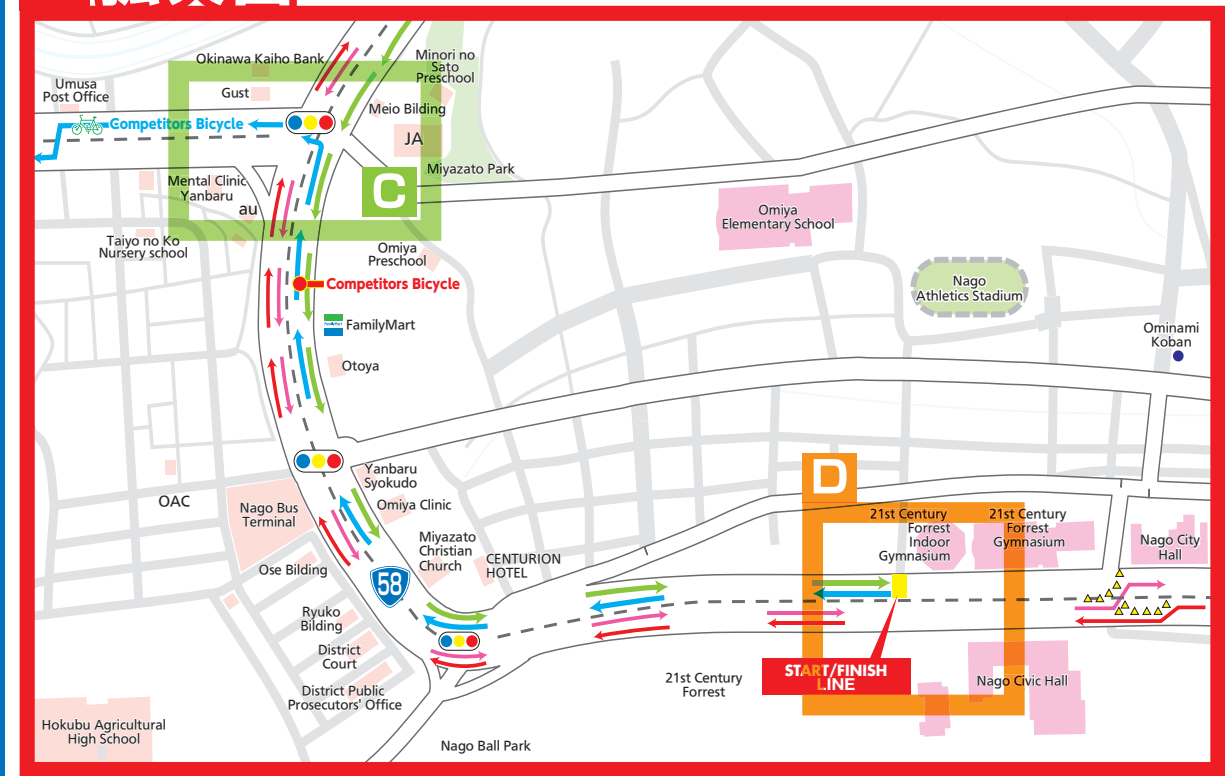

C 拡大図

6:15~8:00

Between 6:15 to 8:00, Miyazato 4-chome (North) intersection can not cut longitudinally. Please divert from Nago Fishing Port before the Gusuku 1-chome intersection.

- General Vehicles
Competitors Bicycle Outward
Competitors Bicycle Return

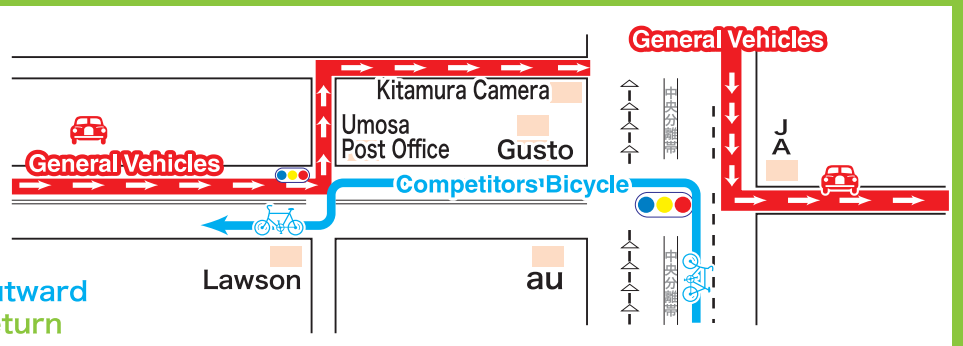

1 8:00~9:50
2 11:40~14:30

1 8:00~9:50, 2 11:40~14:30, from Minato 1-chome intersection Isagawa to the intersection will not be able to cross. Please divert from Yanagibashi nearby Gusuku 1-chome intersection in front of Nago fishing port and AEON Nago shop.

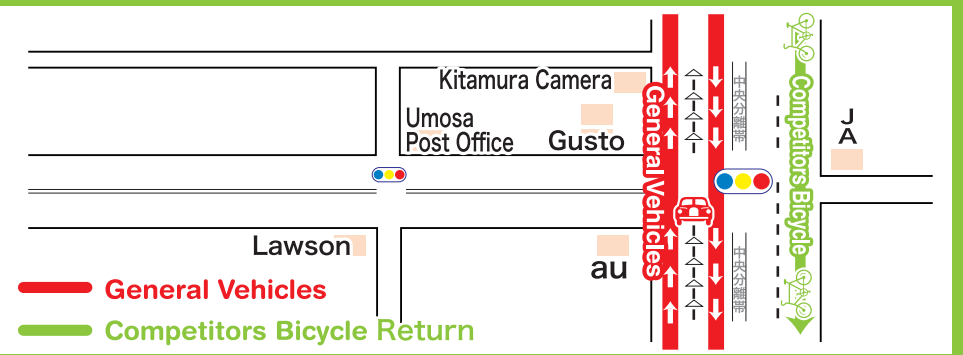

D 拡大図

